

CABLE LUGS A-M

For Cu-conductors

A-M series lugs are manufactured from electrolytic copper tube Cu-OF CW008A conform to UNI EN 13600.

The dimensions of the tube are designed to obtain the most efficient electrical conductivity and mechanical strength to resist vibration and pull out.

Cembre lugs are annealed to guarantee optimum ductility which is an absolute necessity for connectors which will have to withstand the severe deformation arising when compressed and any bending of the palm during installation. In applications subject to vibration, lugs still have to provide a reliable connection and annealing plays a vital role in avoiding cracking or breaks between the barrel and palm.

The presence of an inspection hole facilitates full insertion of the conductor, whilst the barrel length has been designed to allow easy and accurate positioning of the dies during the crimping operation. Lugs are electrolytically tinplated to avoid oxidation.

Larger range and many variations in stud fixing and palm lengths are also available.

Each connector is marked as follows:

- Cembre trade mark and reference number.
- Nature and size of conductor (mm²).
- Ø stud (mm).

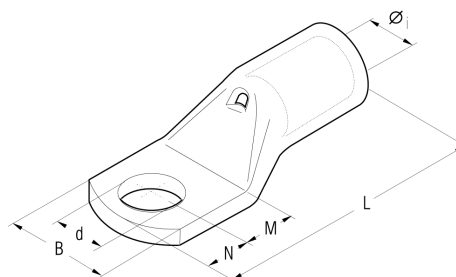

El. no.	Cross section mm ²	Title	Øi	B	M	N	L	d	Quantity in package	Mechanical tools	Hydraulic tools
20 204 00	25	A5-M4	7,0	14,0	5,0	4,0	28,0	4,3	1.000/100	HN-A25	TN70SE TN120SE
20 204 01		A5-M5	7,0	14,0	6,5	6,0	31,5	5,3	500/100		
20 204 02		A5-M6	7,0	14,0	7,0	6,0	32,0	6,4	500/100		
20 204 03		A5-M8	7,0	15,0	9,0	8,0	36,0	8,4	500/100		
20 204 04		A5-M10	7,0	18,0	11,0	10,0	40,0	10,5	500/100		
20 204 05		A5-M12	7,0	21,0	14,0	12,0	45,0	13,2	500/100		
20 204 09	35	A7-M5	8,9	17,0	6,5	6,0	34,0	5,3	500/100		
20 204 10		A7-M6	8,9	17,0	7,0	6,0	34,5	6,4	500/100		
20 204 11		A7-M8	8,9	17,0	9,0	8,0	38,5	8,4	400/100		
20 204 12		A7-M10	8,9	19,0	11,0	10,0	42,5	10,5	400/100		
20 204 13		A7-M12	8,9	21,0	14,0	12,0	47,5	13,2	300/50		
20 204 17	50	A10-M6	10,0	19,0	8,0	7,0	38,5	6,4	200/50		
20 204 18		A10-M8	10,0	19,0	9,0	8,0	40,5	8,4	200/50		
20 204 19		A10-M10	10,0	20,0	11,5	9,5	44,5	10,5	200/50		
20 204 20		A10-M12	10,0	21,0	12,0	12,0	47,5	13,2	200/50		
20 204 21		A10-M14	10,0	25,0	16,0	14,0	55,5	15,0	200/50		
20 204 22		A14-M16	10,0	26,0	18,0	16,0	59,5	17,0	200/50		
20 204 26	70	A14-M8	11,3	21,0	8,0	7,0	44,0	6,4	200/50		
20 204 27		A14-M10	11,3	21,0	9,0	8,0	46,0	8,4	200/50		
20 204 28		A14-M12	11,3	22,0	14,0	12,0	55,0	13,2	150/50		
20 204 29		A14-M14	11,3	25,0	16,0	14,0	59,0	15,0	100/50		
20 204 30		A14-M16	11,3	26,0	18,0	16,0	63,0	17,0	100/50		
20 204 32	95	A19-M6	13,5	25,0	8,0	7,0	50,5	6,4	100/25		
20 204 33		A19-M8	13,5	25,0	9,0	8,0	52,5	8,4	100/25		
20 204 34		A19-M10	13,5	25,0	11,0	10,0	56,5	10,5	100/25		
20 204 35		A19-M12	13,5	25,0	14,0	12,0	61,5	13,2	100/25		
20 204 36		A19-M14	13,5	25,0	16,0	14,0	65,5	15,0	100/25		
20 204 37		A19-M16	13,5	27,0	18,0	16,0	69,5	17,0	100/25		
20 204 38		A19-M20	13,5	29,5	22,0	20,0	77,5	21,0	50/25		

Cont. next page

CABLE LUGS A-M

Cont. for Cu-cable

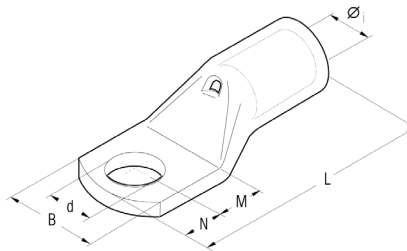

El. no.	Cross section mm ²	Title	Øi	B	M	N	L	d	Quantity in package	Mech. tool		Hydraulic tools					
20 204 40	120	A24-M8	15,2	28,5	11,0	8,0	54,0	8,4	100/25	TN120SE	HT45E	B450ND-BV					
20 204 41		A24-M10	15,2	28,5	11,0	10,0	58,0	10,5	100/25								
20 204 42		A24-M12	15,2	28,5	14,0	12,0	63,0	13,2	100/25								
20 204 43		A24-M14	15,2	28,5	16,0	14,0	67,0	15,0	50/25								
20 204 44		A24-M16	15,2	28,5	18,0	16,0	71,0	17,0	50/25								
20 204 45		A24-M20	15,2	30,0	22,0	20,0	79,0	21,0	50/25								
20 204 47	150	A30-M8	16,7	31,5	13,0	11,0	69,0	8,4	50/25								
20 204 48		A30-M10	16,7	31,5	13,0	11,0	69,0	10,5	50/25								
20 204 49		A30-M12	16,7	31,5	16,0	14,0	75,0	13,2	50/25								
20 204 50		A30-M14	16,7	31,5	18,0	16,0	79,0	15,0	50/25								
20 204 51		A30-M16	16,7	31,5	19,0	17,0	81,0	17,0	50/25								
20 204 52		A30-M20	16,7	31,5	22,0	20,0	87,0	21,0	50/25								
20 204 54	185	A37-M8	19,2	35,5	13,0	11,0	76,0	8,4	50/25								
20 204 55		A37-M10	19,2	35,5	13,0	11,0	76,0	10,5	40/20								
20 204 56		A37-M12	19,2	35,5	16,0	14,0	82,0	13,2	40/20								
20 204 57		A37-M14	19,2	35,5	18,0	16,0	86,0	15,0	30/15								
20 204 58		A37-M16	19,2	35,5	19,0	17,0	88,0	17,0	30/15								
20 204 59		A37-M20	19,2	35,5	22,0	20,0	94,0	21,0	30/15								
20 204 61	240	A48-M8	21,1	39,0	13,0	11,0	77,5	8,4	30/15								
20 204 62		A48-M10	21,1	39,0	13,0	11,0	77,5	10,5	30/15								
20 204 63		A48-M12	21,1	39,0	14,0	12,0	79,5	13,2	30/15								
20 204 64		A48-M14	21,1	39,0	18,0	16,0	92,0	15,0	30/15								
20 204 65		A48-M20	21,1	39,0	22,0	20,0	100,0	21,0	30/15								
20 204 67	300	A60-M10	23,7	44,0	20,0	11,0	96,0	10,5	20/10								
20 204 68		A60-M12	23,7	44,0	20,0	14,0	99,0	13,2	20/10								
20 204 69		A60-M14	23,7	44,0	22,0	16,0	103,0	15,0	20/10								
20 204 70		A60-M16	23,7	44,0	22,0	19,0	106,0	17,0	20/10								
20 204 71		A60-M20	23,7	44,0	24,0	23,0	112,0	21,0	20/10								
20 204 74	400	A80-M12	27,0	51,0	22,0	19,0	113,0	13,2	20/5								
20 204 75		A80-M14	27,0	51,0	22,0	19,0	113,0	15,0	15/5								
20 204 76		A80-M16	27,0	51,0	22,0	19,0	113,0	17,0	15/5								
20 204 77		A80-M20	27,0	51,0	24,0	23,0	119,0	21,0	15/5								
20 204 80	500	A100-M16	30,3	56,5	22,0	19,0	117,0	17,0	15/5								
20 204 81		A100-M20	30,3	56,5	24,0	23,0	123,0	21,0	15/5								
20 204 84	630	A120-M16	33,4	61,6	22,0	19,0	128,0	17,0	12/1								
20 204 85		A120-M20	33,4	61,6	24,0	23,0	134,0	21,0	10/1								
20 204 86	800	A160-M16	38,0	72,0	24,0	19,0	141,0	17,0	6/1								
20 204 87		A160-M20	38,0	72,0	24,0	23,0	145,0	21,0	6/1								
20 204 88		1000	A200-M16	44,0	80,0	24,0	19,0	158,0	17,0	6/1							
20 204 89	A200-M20		44,0	80,0	24,0	23,0	162,0	21,0	6/1								

CABLE LUGS A-M

For Cu-cable, L.V circuit breakers
Ring tongue terminals with contained palm

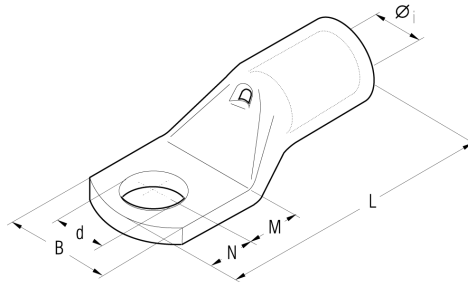

El. no.	Cross section mm ²	Title	Øi	B	M	N	L	d	Quantity in package	Mechanical tools				Hydraulic tools						
										HNS	HN-A25	TN70SE	TN120SE	B15MD	HT45E B450ND-BV	HT51	RH50 B500 B500ND	HT81-U RHU81	HT120 and tools with 130kN	ECW-H3D
20 204 90	10	A2-M5/9	4,6	9,0	6,5	6,0	26,0	5,3	1.000/100											
20 204 91	16	A3-M5/9	5,8	9,0	6,5	6,0	29,0	5,3	1.000/100											
20 204 92	25	A5-M5/9	7,0	9,0	6,5	6,0	31,5	5,3	500/100											
20 204 95	35	A7B-M6/11.5	8,9	11,5	8,0	7,0	36,5	5,3	400/100											
20 204 96	50	A10B-M6/11.5	10,0	11,5	8,0	7,0	40,5	6,4	200/50											
20 204 99	70	A14B-M6/11.5	11,3	11,5	8,0	7,0	44,0	6,4	200/50											
20 205 00	95	A19B-M8/15.5	13,5	15,5	9,0	8,0	52,5	6,4	100/25											
20 205 03	120	A24B-M8/19	15,2	19,0	14,0	9,0	60,0	8,4	100/25											
20 205 05		A24B-M10/19	15,2	19,0	14,0	9,0	60,0	8,4	100/25											
20 205 06	150	A30B-M8/19	16,7	19,0	18,0	9,0	70,0	8,4	50/25											
20 205 06		A30B-M10/19	16,7	19,0	18,0	9,0	70,0	10,5												
20 205 08	185	A37B-M10/24.5	19,2	24,5	18,0	9,0	77,0	10,5	50/25											
20 205 09	240	A48-M10/31	21,1	31,0	13,0	9,0	80,0	10,5	50/25											
20 205 10		A48-M12/31	21,1	31,0	16,0	12,0	86,0	10,5	30/15											
20 205 11	300	A48-M16/31	21,1	31,0	19,0	17,0	94,0	13,2	30/15											
20 205 12		A60B-M10/31	23,7	31,0	16,0	12,0	95,0	17,0	20/10											
20 205 13		A60B-M12/31	23,7	31,0	16,0	17,0	95,0	13,2	20/10											