

Additional equipment

for screened (touch-proof) connectors

PAK 630. Test adapter for CB connectors.

Set of 3 pieces El.nr. 11 318 68

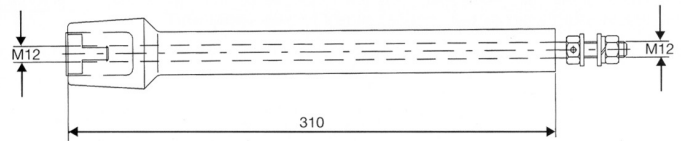

CP 630-C. Coupling-kon between 2
CB connectors.

Set of 3 pieces. El.nr. 11 318 69

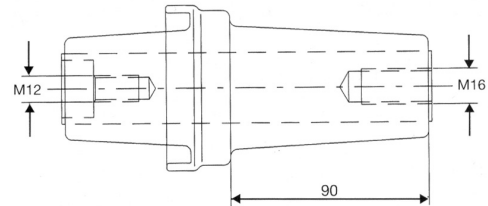

EAS 630. Blind point for CB connectors.

Set of 3 pieces. El.nr. 11 318 70

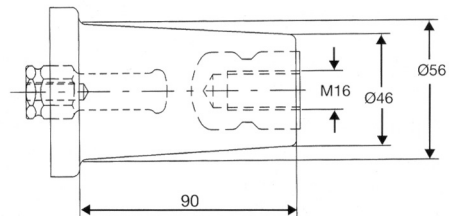

E20. Earthed adapter for CB kontakt.

Ball dia. 20 mm: Set of 3 pieces. El.no 11 318 72

Ball dia. 25 mm: Set of 3 pieces. El.no 11 318 73

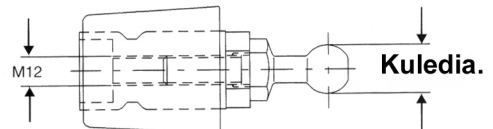

CP 630/250 ST. Reduction Plug for T-connector.

Mounted in a T-connector, first remove the insulation plug.

When reduction plug is installed, connect an elbow or
straight connector directly to 250 Ampers part of the plug.

NB! Disassembly / Assembly should never happen until
voltage measurement and the necessary grounding of the
work is done. Particularly suited to the provisional pairing of
transformer cable and main cable in a supply network.

Set of 3 pieces. El. nr. 11 317 55

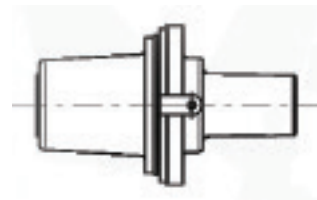

Additional equipment

for screened (touch-proof) connectors

EAS 250. Blind point for CB connectors.
Set of 3 pieces. El.no. 11 318 71

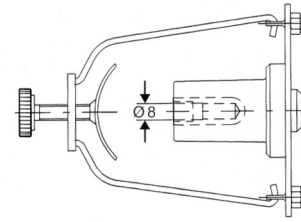

E250. Earth adapter for EASW contact.
Ball dia. 20 mm: Sett a 3 stk. El.no. 11 318 74
Ball dia. 25 mm: Sett a 3 stk. El.no. 11 318 75

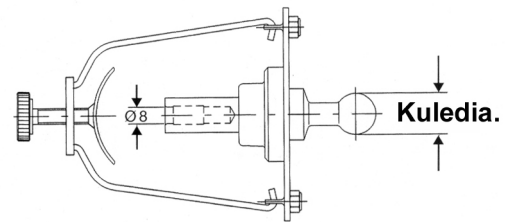

K250/630. Coupling-kon between K250-630Amp.
Set of 3 pieces. El.no. 11 315 65

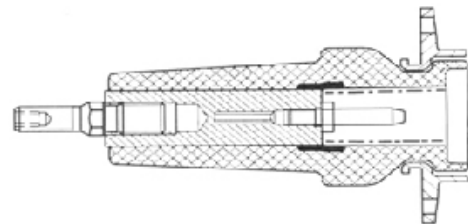

CBC 36-630. Insulation cap for standard 630A kon.
Set of 3 pieces. El. no. 11 323 34

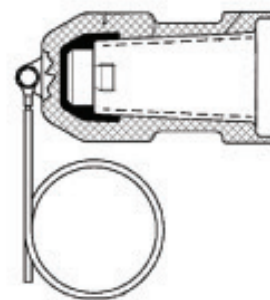

Wedge for CB/CC. Dismantling wedge is used to ventilate into the air when removing the rear plug in shielded connectors. 1 pcs. El no. 88 402 33

